



Installation Instructions

Complete set active Sound incl. Soundbooster

BMW 3er F31

v1.3 (03.11.2017)

Contents

1	Liability Exclusion	3
2	Copy Right	4
3	General Notes	4
4	Safety instructions	5
5	Requirements for the determinable operation	5
6	Note	5
7	How to connect a cable to another	6
8	Note Cable Inscription/Color	7
9	Assembly Instructions	8
10	Removing trim panel passenger's side	9
11	Removing trim panel passenger's side rear	10
12	Removing trim panel trunk	11
13	Removing trim panel trunk	12
14	Connection cable set	13
15	Installation pushbutton	14
16	Routing cable set	15
17	Routing cable set to the underbody	16
18	Routing wire of ignition lead	17
19	Removing trim panel underbody	18
20	Installation sound generator	19
21	Important Information Sound Booster	20

1 Liability Exclusion

Dear Customer

Our cable sets are developed according to the connection- and circuit diagrams of the corresponding car manufacturer. Before the original production the cable sets will be tested on an original car. Therefore, the integration into the car electronics will be executed according to the instructions of the manufacturer. Regarding the necessary pre-understanding and the accuracy of the presentation of texts and pictures our mounting guidelines correspond to the usual ones in car technology and car electronics. Practically, they have been proved one's worth a hundred times.

However, should there be any difficulties during the installation of our products we will be at your disposal any time for support by phone or by mail. Moreover, we offer you to execute the installation at our works in Bad Segeberg.

Costs which may arise because a third person will execute the installation of our products will not be supported by us in any case. Only if there is a mistake caused by our product we will pay the proved costs of the installation as well as the costs of the removal of the defective product. The refund of expenses will be limited to gross EUR 110,- ; we reserve the right to check the described mistake in our works in Bad Segeberg. In case of a proved reclamation the costs for dispatch for the check in our factory will be transferred to you.

According to our experience each specific factory which has the necessary diagnostic device, diagnostic software and the circuit diagrams of the manufacturer can find possible mistakes at our products within a short time. So the installation and removal including diagnostic inspection can be realised in at most 60 minutes.

We also made the experience that many specific factories cannot work with the circuit diagrams of the manufacturer, and that they cannot read usual wiring diagrams. Therefore, very easy installation works will take many hours. You will understand that we neither take the risk to find a reliable specific factory nor the financing of the training of the staff of your favoured factory.

Costs which will arise because you buy missing parts or spare parts at other suppliers will be refunded by us up to the amount of the costs which had been arisen by additional supply (saved expenses). In this case, there would be no right for refund according to the legal guarantee right as long as we have no deadline for supplementary performance or a deadline for supplementary performance has not expired.

So if you have any problems with the installation or operation of one of our products please call us, send us an email, send us the product or take your car to our factory in Bad Segeberg. We are sure to find an appropriate solution for each concern.

With best regards
Your Kufatec GmbH & Co. KG Team

2 Copy Right

Our installation- and removal instructions, installation plans, software and other documentation with texts or pictures are protected by copy right.

A publication or distribution of these documents is only permitted with a written approval of Kufatec GmbH & Co. KG.

3 General Notes

Regarding the development there has especially been paid attention to your personal safety together with the most possible operating comfort, modern design and actual product technologies.

Despite most possible accuracy in case of incorrect installation or use or in case of incorrect operating, it is possible that injuries or damages of property may arise.

Therefore, please read the operating instructions you have received carefully and completely, and keep it with you.

All articles of our production will be checked at 100% — for your safety.

We reserve the right to make technical changes which serve the progress at any time.

Before the installation or startup it may be necessary, depending on the article and purpose of use, to check the legal instructions of each country.

In case of warranty claim the device has to be sent to the seller originally packed together with the sales receipt and a detailed description of the mistake. Please consider the manufacturer's instructions for return (RMA). The legal warranty instructions are valid.

The warranty claim and also the permission for startup will expire in case of:

- unauthorised changes on the device or the accessories which have not been executed or approved by the manufacturer or its partners
- opening of the box
- repair of the device on your own
- incorrect use / no normal use / startup
- influence of force on the device (falling down, wilful damage, accident, etc.)

During the installation please consider all safety and legal instructions. The device may only be installed by trained qualified personnel or persons who are similar qualified.

In case of installation- or function problems please reduce the search of the mistake to approx. 0,5 hours for mechanical works or 1,0 hours for electronic works.

To avoid unnecessary additional work and expenses, please send immediately an inquiry to our technical support with the Kufatec contact form (<http://www.kufatec.de/shop/de/infocenter/>)

Please absolutely mention the following:

- car chassis number
- part number of the add-on kit
- exact description of the problem
- work steps already made

4 Safety instructions

The installation may only be executed by trained qualified personnel. Please execute the installations only in a condition of dead voltage. Here please separate for example the battery from the main power supply and consider the instructions of the car manufacturer.

- In order to not endanger your own driving safety please never use security relevant screws, bolts or other fixation pieces at steering, brake system or other components.
- Connect the device only at 12V wiring system voltage with ground connection to the autobody. This assembly is not allowed for the use in trucks or other cars with 24V wiring system voltage.
- Please avoid the installation of the device at positions where the driving safety or the functional efficiency of other subassembly integrated in the car are restricted.
- This module may only be used together with the following mentioned car types and models; the installation may be executed exclusively by use of the circuit points mentioned in the assembly instructions.
- Kufatec GmbH & Co. KG does not assume liability for damages which are caused by incorrect installation, the use of inapplicable circuit points or the installation into car types and -modules which are not foreseen.
- We would like to draw your attention to the fact that the module processes the data of the MOST-protocol of the car mentioned below. Therefore, during the installation of the module it will be used a model-specific complete system which we as the manufacturer of the mentioned construction line only know partly.
- Especially in case of changes within the same model line and the same year we therefore cannot guarantee the applicability of our construction line in each case. Kufatec GmbH & Co. KG does not assume liability for the applicability of our construction line with changes made by the manufacturer.
- Kufatec GmbH & Co. KG does not assume liability that the installation of the here described component has been permitted according to the guarantee instructions of particular car manufacturers. Therefore, please consider the guidelines for installation and guarantee conditions of your car manufacturer before installation.
- The manufacturer reserves the right to change components without giving reasons.
- Subject to errors and changes

5 Requirements for the determinable operation

Please use the device only in its the corresponding area.

In case of unprofessional and untypical use, installation or modification the permission for operation and the warranty claim will expire.

6 Note

Make sure that there's enough space at the described position. If there is no space please cancel the installation and contact our technical support.

The use of a sound booster is not permitted without registration in the vehicle papers, in the area of the german StVZO. The noise emission of the vehicle is increased by this retrofit. The regulations of the StVZO must be observed. It is therefore recommended to ask for a specific registration option at the responsible TÜV/DEKRA office before retrofitting. Outside Germany, please observe the laws on vehicle licensing applicable in your country.

7 How to connect a cable to another

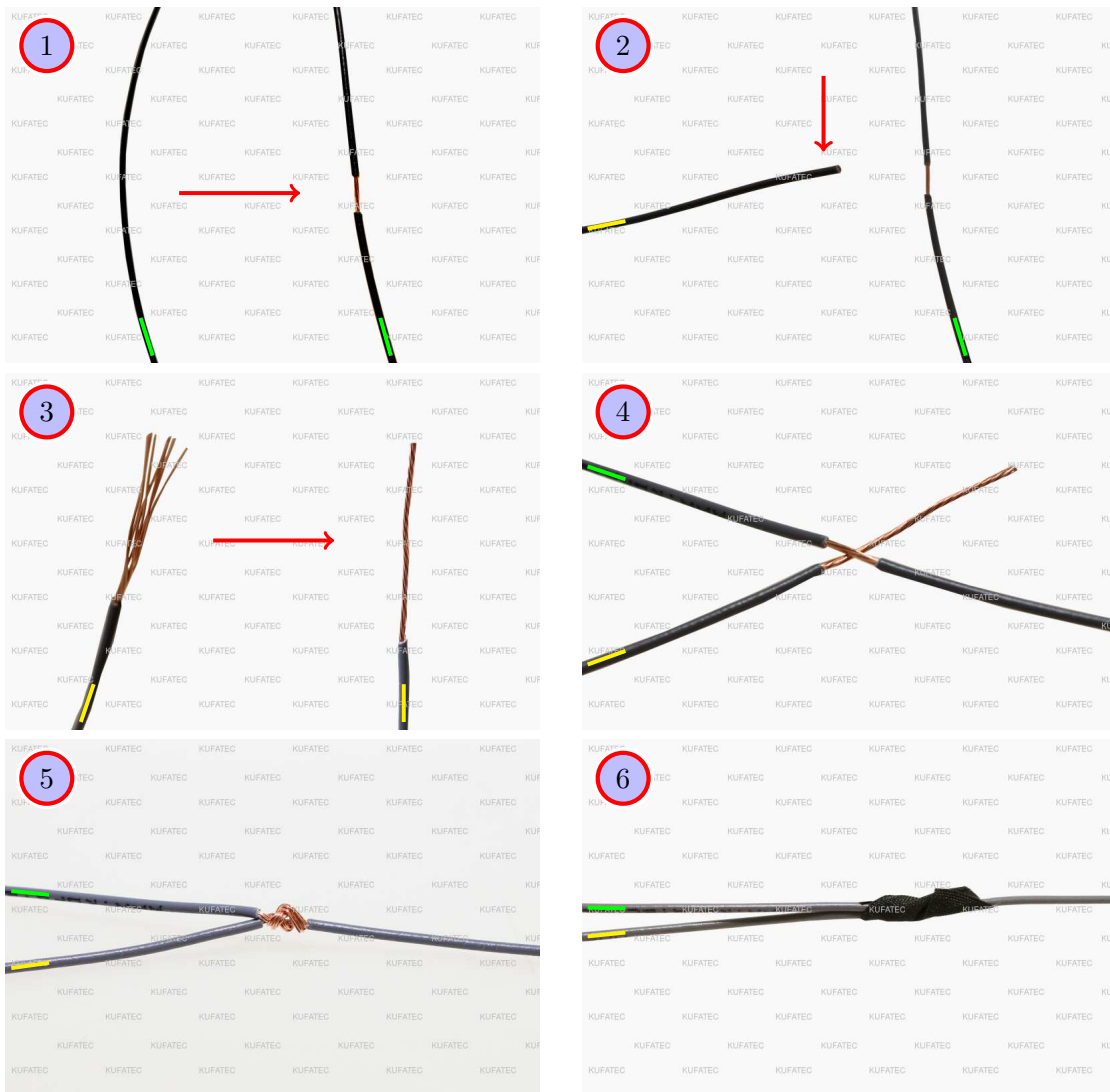

Figure 1: How to connect a cable to another

Table 1: How to connect a cable to another

No.	Work step	Note
1	Take the cable of the vehicle, to which you want to connect, (green marked here) and strip the insulation at one point with a suitable tool (cable stripper/cutter knife).	
2	Now take the cable of the cable set, which you want to connect, (yellow marked here) and strip the insulation at the end.	
3	Twirl the wires of the stripped cable together.	
4	Place the end of the cable you want to connect under the stripped point of the cable of the vehicle...	
5	... and wrap the cable you want to connect around the cable of the vehicle.	
6	Lastly, stick insulating tape around the connection point.	

8 Note Cable Inscription/Color



Figure 2: Cable Inscription

If our cable set consists exclusively of grey wires, connect the wires according to the cable inscription.

9 Assembly Instructions

The following illustration shows the cable routing as well as the position of the individual components.

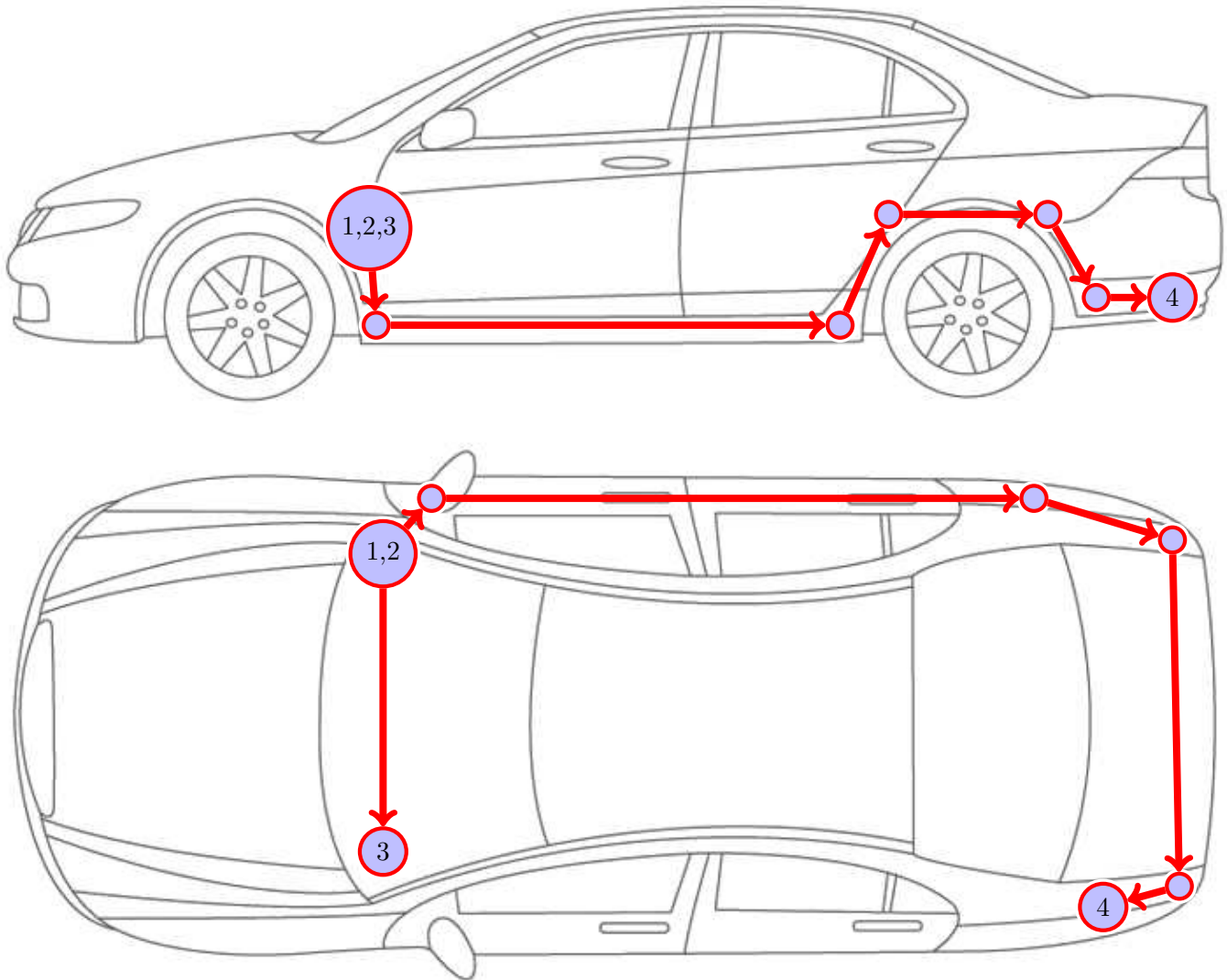

Figure 3: Vehicle overview

- 1 Control unit for engine sound generation
- 2 Connection cable set
- 3 Pushbutton
- 4 External sound generator incl. mounting plate

10 Removing trim panel passenger's side

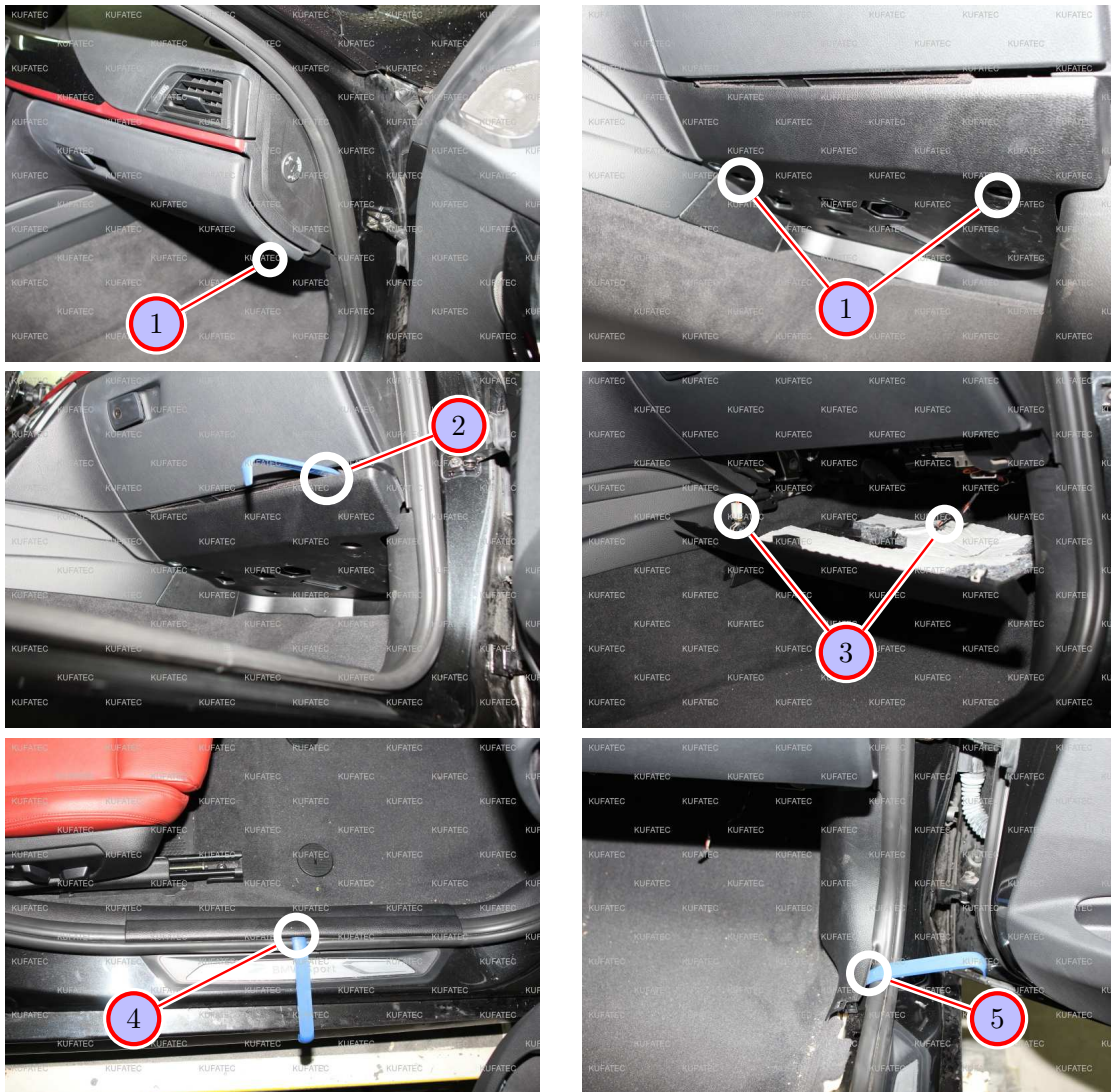

Figure 4: Removing trim panel passenger's side

Table 2: Removing trim panel passenger's side - instructions

Nr.	Work step	Note
1	Loosen the two marked screws of the lower trim panel of the dashboard on the passenger's side.	2x10er socket
2	Loosen the trim panel with a trim tool and pull it down.	
3	Remove the plug connections and take the trim panel out completely.	
4	Loosen and remove the sill trim on the passenger's side using a trim tool.	
5	Remove the lower trim panel of the a-pillar by loosening it with a trim tool.	

11 Removing trim panel passenger's side rear

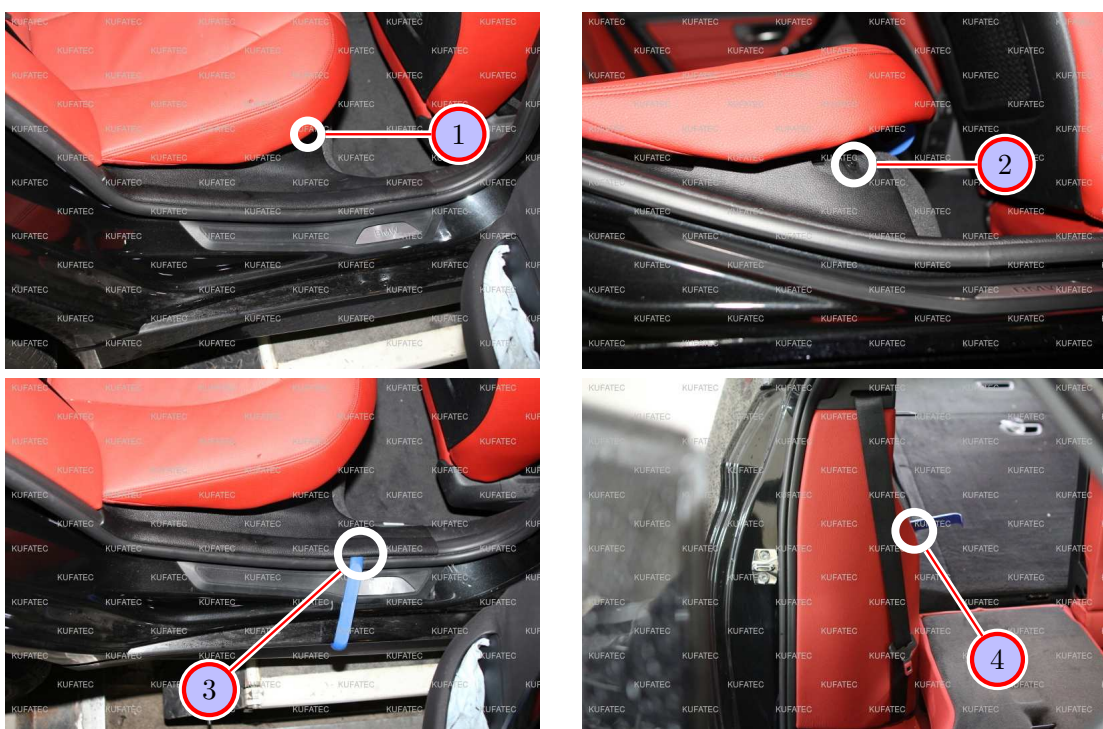

Figure 5: Removing trim panel passenger's side rear

Table 3: Removing trim panel passenger's side rear - instructions

Nr.	Work step	Note
1	Pull the back seat at the marked point a bit up carefully.	
2	Remove the marked plastic clip using a trim tool.	
3	Loosen and remove the sill trim with a trim tool.	
4	Loosen the lateral cushioning at the top with a trim tool and pull it up afterwards.	

12 Removing trim panel trunk



Figure 6: Removing trim panel trunk

Table 4: Removing trim panel trunk - instructions

Nr.	Work step	Note
1	Remove the trunk floor out of the trunk.	
2	Loosen the three marked plastic clips of the right front side trim panel using a trim tool.	
3	Now remove the front side trim panel using a trim tool.	
4	Loosen and remove the left front side trim panel in the trunk.	

13 Removing trim panel trunk

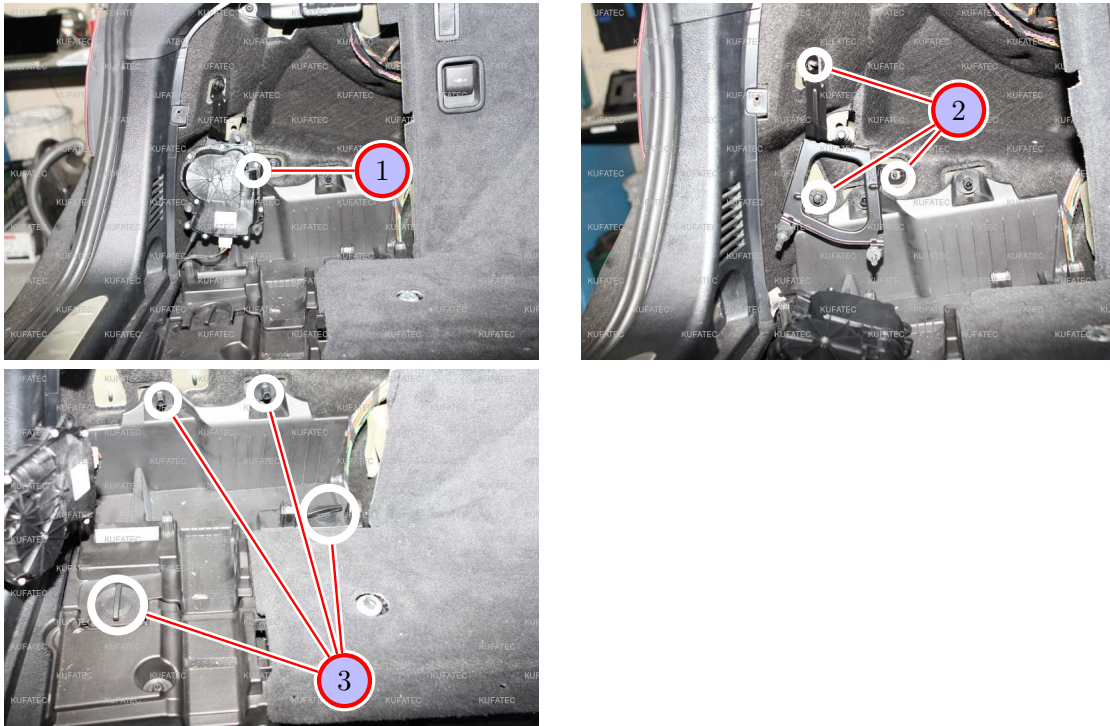

Figure 7: Removing trim panel trunk

Table 5: Removing trim panel trunk - instructions

Nr.	Work step	Note
1	Move the control unit off from the bracket.	
2	Remove the marked screws of the bracket and take it out afterwards.	3x10er socket
3	Take the lower trim panel out by loosening the marked screws as well as the interlocks.	2x10er socket

14 Connection cable set

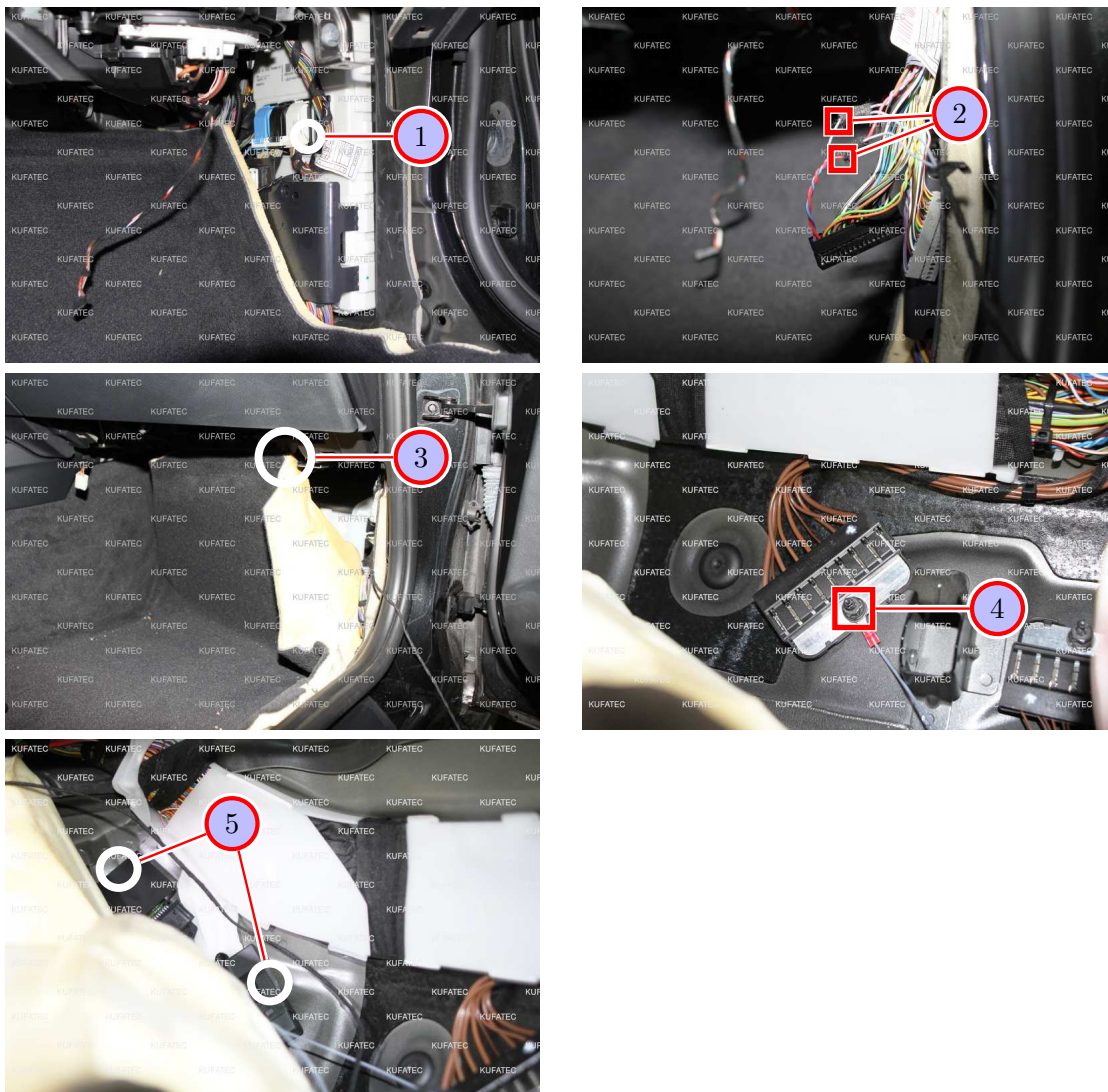

Figure 8: Connection cable set

Table 6: Connection cable set - instructions

Nr.	Work step	Note
1	Move the marked white plug off from the control unit at the a-pillar of the passenger's side and remove the plug housing.	
2	Now connect CAN High & Low as follows: - Solder CAN High (black/white) also on PIN 36 (blue/red). - Solder CAN Low (black/yellow) also on PIN 35 (red). If our cable set consists exclusively of grey wires, please connect the cables according to the cable inscription at the end of the wires.	
3	Pull the carpet forward carefully.	
4	Connect the ground cable (brown) also to the marked ground spot under the carpet.	10er socket
5	Connect the control unit and the module to the cable set and place them under the carpet at the marked positions.	

15 Installation pushbutton

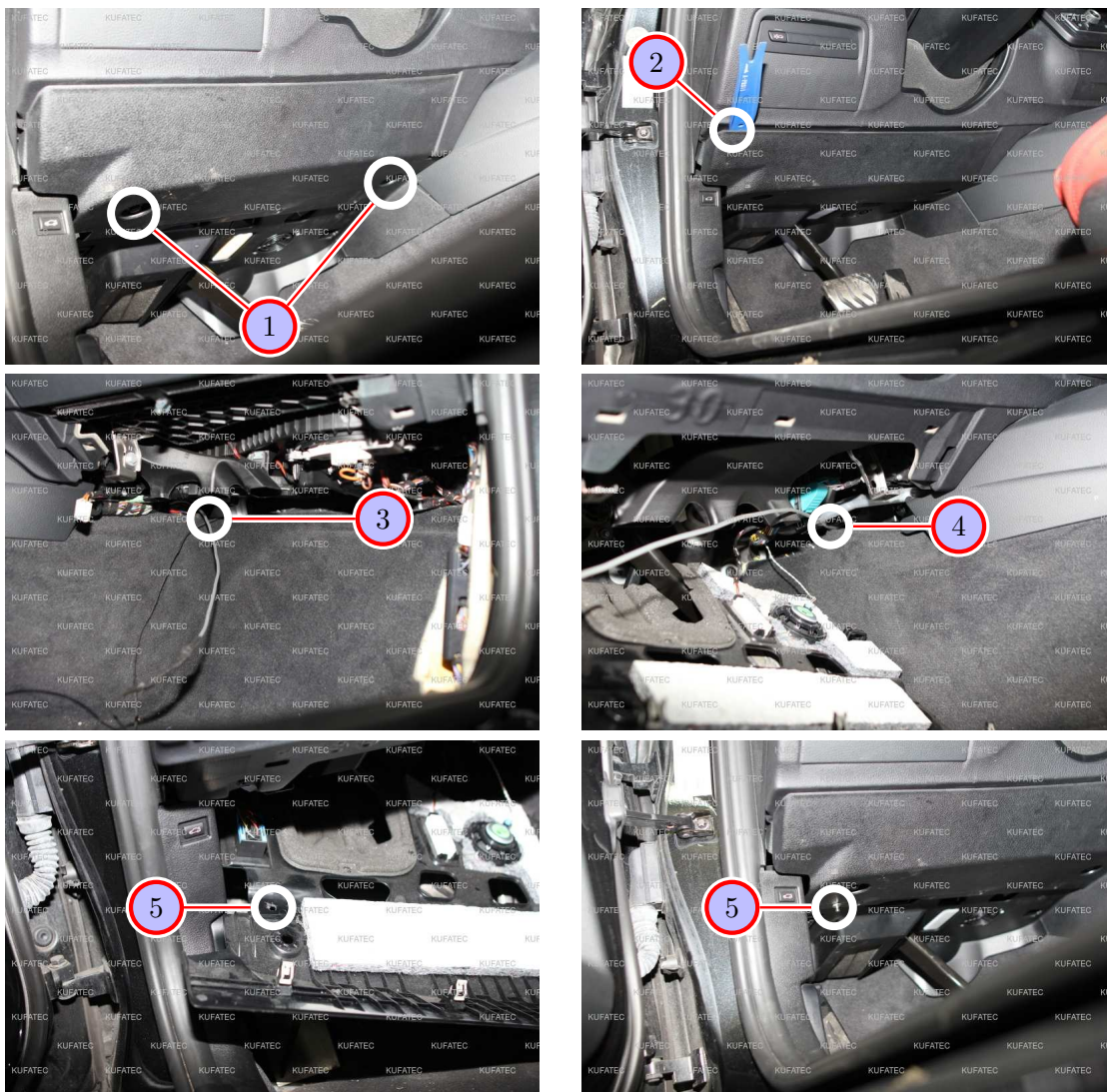

Figure 9: Installation pushbutton

Table 7: Installation pushbutton - instructions

Nr.	Work step	Note
1	Loosen the marked screws of the lower trim panel of the dashboard.	2x10er socket
2	Loosen the lower covering using a trim tool and pull it down carefully.	
3	Guide the cable for the pushbutton behind the center console to the driver's side using a pull through aid.	
4	Pull the cable for the pushbutton out from behind the center console.	
5	Drill a hole for the pushbutton at the marked position and install it afterwards.	7mm

16 Routing cable set

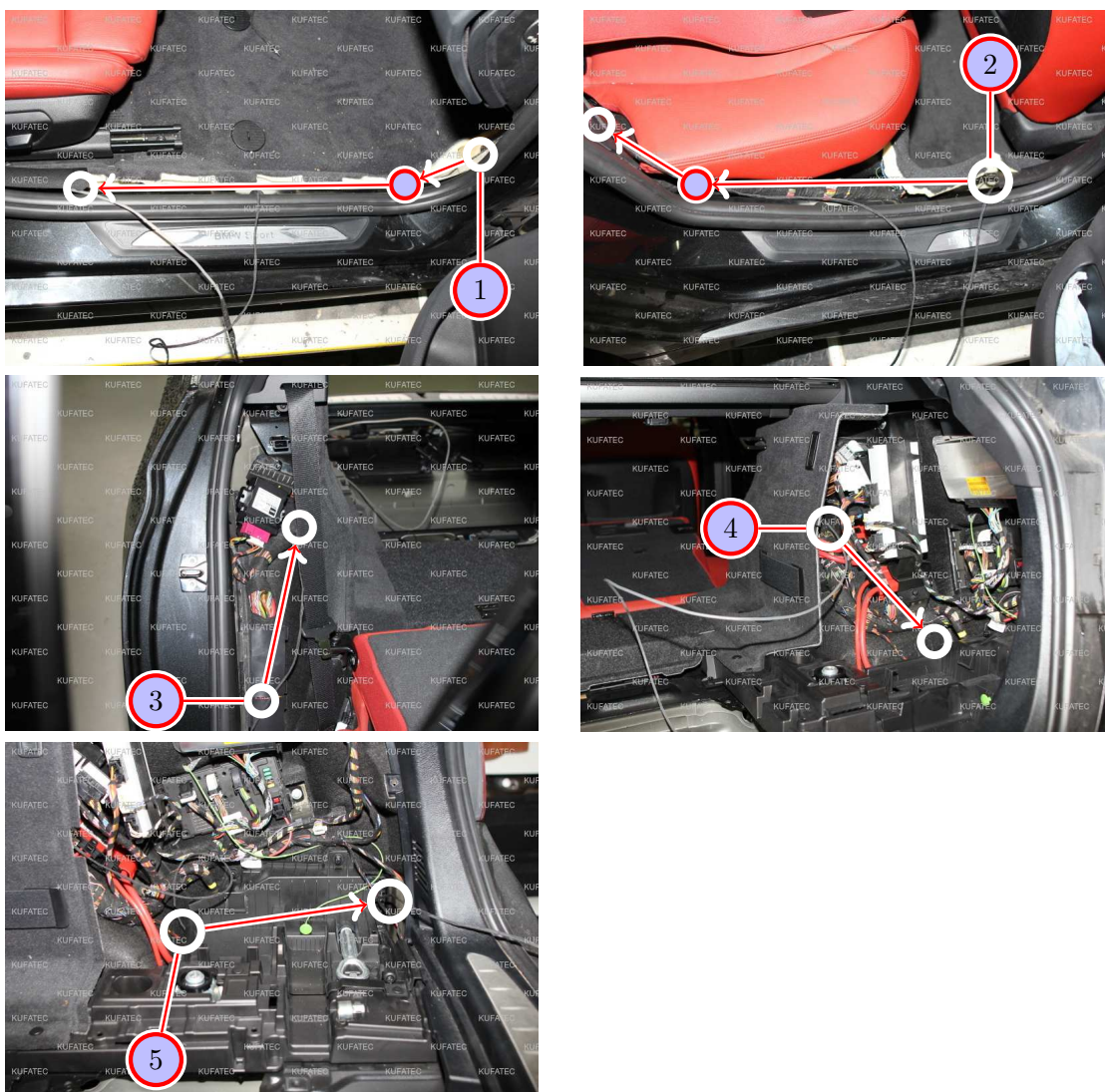

Figure 10: Routing cable set

Table 8: Routing cable set - instructions

Nr.	Work step	Note
1	Route the connecting cable of the sound generator as well as for ignition lead along the front sill trim to the b-pillar.	
2	Pull both wires out from under the trim panel of the b-pillar and route them along the marking up to the c-pillar.	
3	Now guide the connecting cable for the sound generator with a pull through aid behind the side trim panel in the trunk.	
4	Pull the connecting cable out from behind and route it down to the covering.	
5	Guide the connecting cable along under the covering to the trunk sill protection.	

17 Routing cable set to the underbody

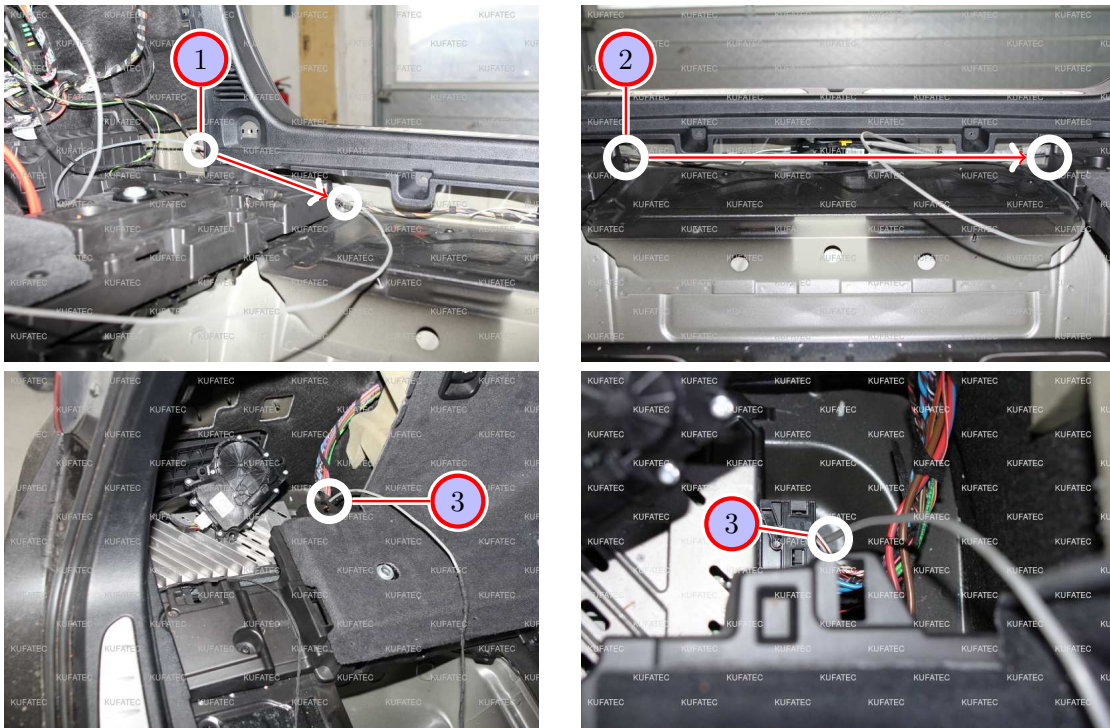

Figure 11: Routing cable set to the underbody

Table 9: Routing cable set to the underbody - instructions

Nr.	Work step	Note
1	Guide the connecting cable for the sound generator through behind the trim panel.	
2	Route the connecting cable along the marking to the driver's side in the trunk.	
3	Now guide the connecting cable for the sound generator with a pull through aid through the marked grommet to the underbody.	

18 Routing wire of ignition lead

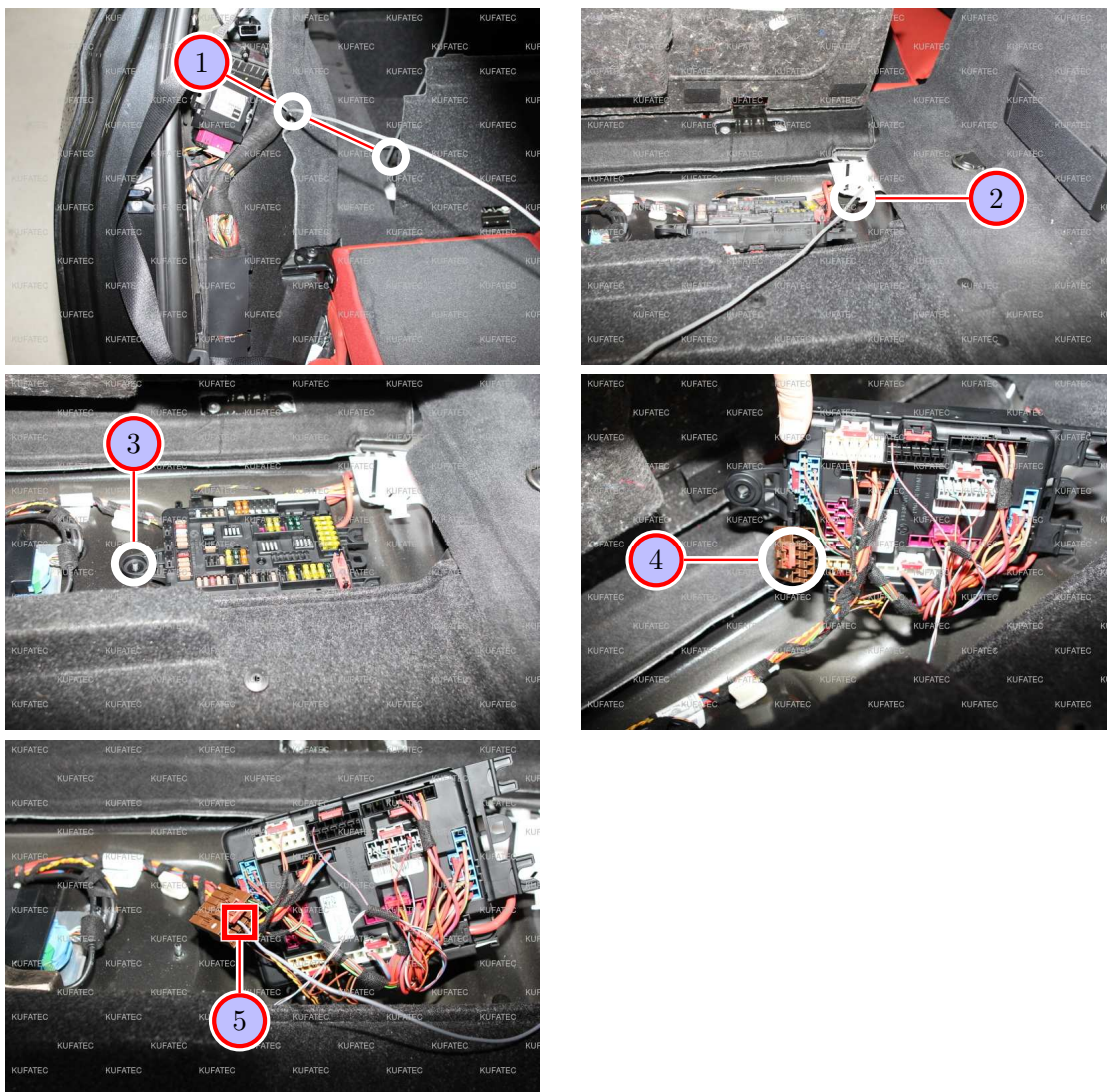

Figure 12: Routing wire of ignition lead

Table 10: Routing wire of ignition lead - instructions

Nr.	Work step	Note
1	Guide the cable for ignition lead (red/white) behind the trim panel down to the fuse box in the trunk.	
2	Pull the wire out from behind the trim panel.	
3	Loosen the marked screw of the fuse box and pull it up out carefully.	1x10er socket
4	Loosen the brown fuse carrier out of the fuse box.	
5	Place the cable for ignition lead (red/white) in the third fuse spot (counted top down). In our case a blue 15 ampere fuse was located there in the carrier. Before you connect the wire, measure if ignition lead (terminal 15) is placed there and goes also out after turning the ignition off. If this is not the case, check on which alternative fuse spot ignition lead is placed.	

19 Removing trim panel underbody

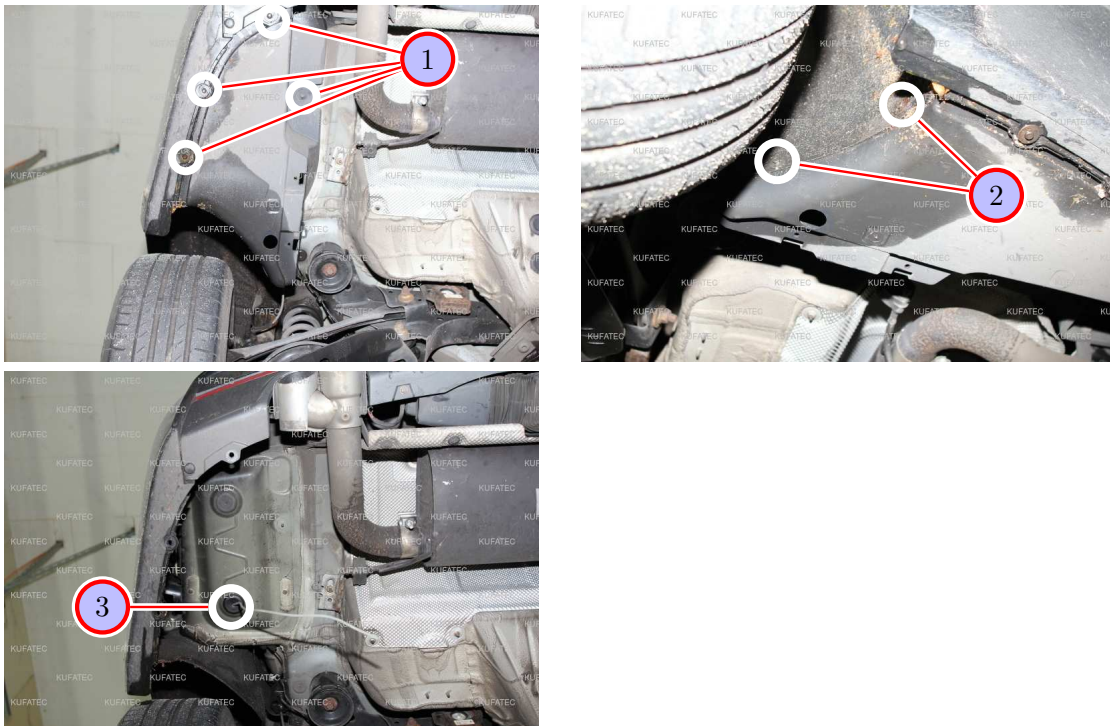

Figure 13: Removing trim panel underbody

Table 11: Removing trim panel underbody - instructions

Nr.	Work step	Note
1	Loosen the marked screws of the lower covering.	3x8er socket, 1x10er socket
2	Now remove the two marked screws of the covering at the underbody in the wheel housing and take the covering out afterwards.	2x8er socket
3	Pull the connecting cable of the sound generator further through.	

20 Installation sound generator

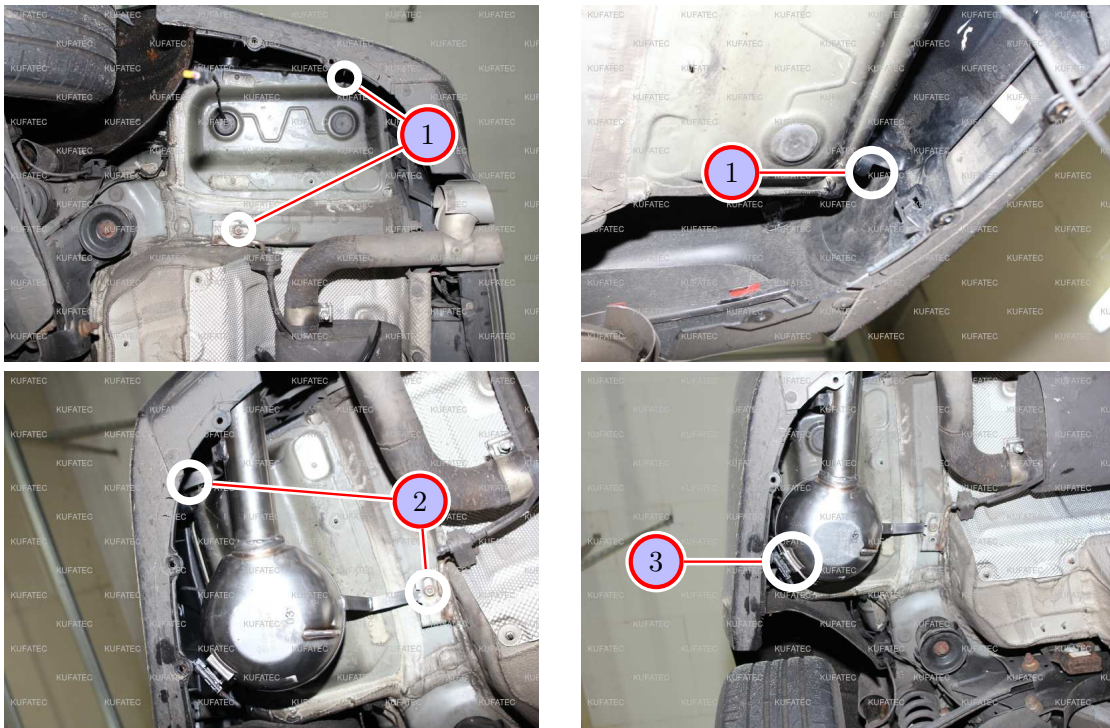

Figure 14: Installation sound generator

Table 12: Installation sound generator - instructions

Nr.	Work step	Note
1	Loosen the marked screws of the exhaust bracket as well as of the lateral bracket of the bumper.	2x10er socket
2	Afterwards install the sound generator with the just loosened screws.	2x10er socket
3	Connect the connecting cable to the sound generator and attach the steel wire rope to the vehicle as well as to the sound generator.	

21 Important Information Sound Booster

Please use for the fixation of the Sound Booster suitable high tensile screws. In order to avoid loosening of the screws by vibration please make the screws safe with appropriate factory material e.g Threadlock. Please additionally check the stability of the Sound Booster regularly and if necessary retighten the screws. In case of no consideration we do not assume liability for possible damages. After successful installation we recommend to cover the sound generator with a zinc spray. Make sure that you cover the opening of the sound generator so that no zinc spray can't get inside the sound generator.

As additional safety the delivered steel cable and the retaining clips have to be tightened on the Sound Booster as well as at a suitable position in the car. This safety cable is an additional security should the tightening screws should be released by vibration.

List of Figures

1	How to connect a cable to another	6
2	Cable Inscription	7
3	Vehicle overview	8
4	Removing trim panel passenger's side	9
5	Removing trim panel passenger's side rear	10
6	Removing trim panel trunk	11
7	Removing trim panel trunk	12
8	Connection cable set	13
9	Installation pushbutton	14
10	Routing cable set	15
11	Routing cable set to the underbody	16
12	Routing wire of ignition lead	17
13	Removing trim panel underbody	18
14	Installation sound generator	19

List of Tables

1	How to connect a cable to another	6
2	Removing trim panel passenger's side - instructions	9
3	Removing trim panel passenger's side rear - instructions	10
4	Removing trim panel trunk - instructions	11
5	Removing trim panel trunk - instructions	12
6	Connection cable set - instructions	13
7	Installation pushbutton - instructions	14
8	Routing cable set - instructions	15
9	Routing cable set to the underbody - instructions	16
10	Routing wire of ignition lead - instructions	17
11	Removing trim panel underbody - instructions	18
12	Installation sound generator - instructions	19